

## FM-2 Operating Procedure

We thank you for the purchase of FM-2 Type Field Master of our products.

In order to ensure proper equipment performance, please read this Operating Procedure to the end before using our products.

This Operating Procedure should be carefully stored and referred to when necessary. Please use this equipment forever.

However, since this unit may be used in a wide variety of situations, this Operating Procedure may not cover every case.

### In order to be used safely:

The following notice items are described in order to ensure proper usage and to prevent injury to operators or equipment damage.

<b>⚠ WARNING</b>	If you disregard this information, there is a possibility of death and a likelihood of serious personal injury and/or damage to property.
<b>⚠ CAUTION</b>	If you disregard this information, there is a possibility of injury and a likelihood of damage to the equipment or other property.

This equipment is produced for use in Japan. In the case that it is used in other countries, you should observe the laws and regulations related to safety in such countries.

In the case that this equipment is delivered to some other party, it is necessary to deliver this Operating Procedure together with the equipment.

### **⚠ WARNING**

Never modify, disassemble, or repair this system. If the machine needs to be serviced, please contact us. We will not be responsible for malfunctions or other problems caused by unauthorized service or repairs.

Adjust the only when the press ram has been raised and is stopped. Make sure that no one is near the controls. If another person mistakenly pushes the pushbutton switch during adjustment, there is a danger of injury to a person.

### **⚠ CAUTION**

Please use within the rated capacity of the load cell. Doing so beyond the rating may cause malfunctions or malfunctions.

Use this machine at ambient temperatures between 0 and 50°C. Do not place the system in direct sunlight and or near hot air. Use of the machine in conditions other than those specified may cause a malfunction.

- 1) Take the FM-2 measuring instrument, the load cell, the pressure disc and the plug conversion cable out of the dedicated case.

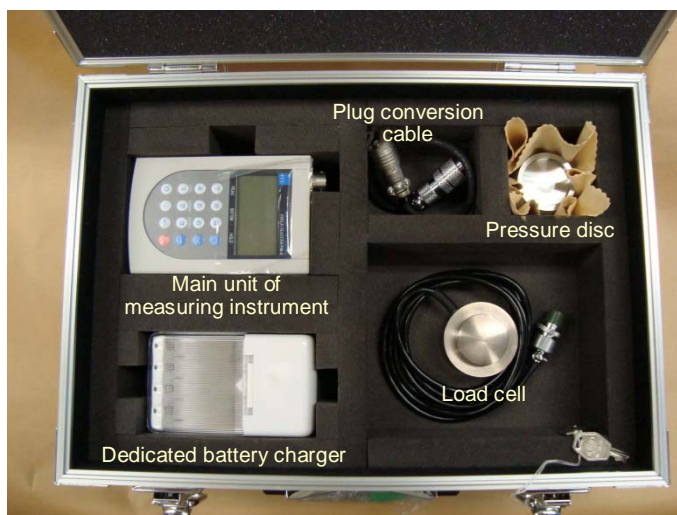

- 2) Connect the plug conversion cable to the FM-2 measuring instrument.

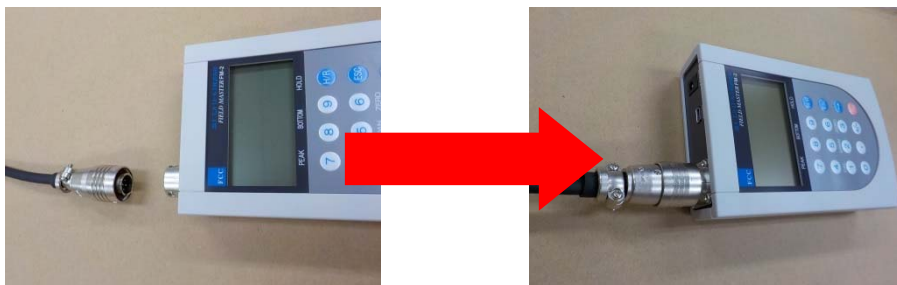

- 3) Connect the load cell and the plug conversion cable.

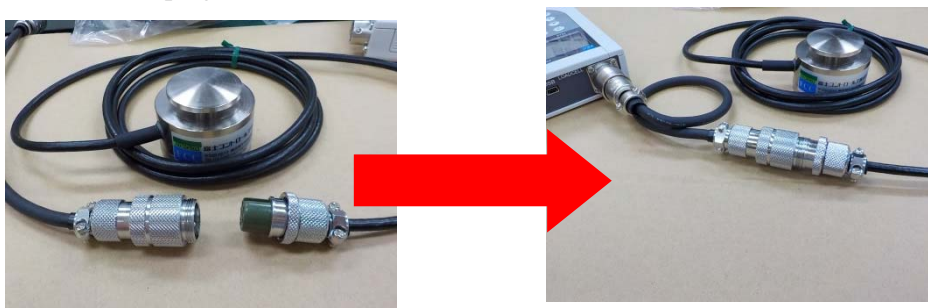

- 4) Place the load cell on the press base surface and place the pressure disc on the load cell.



5) Adjust the position visually.



6) Turn the power switch ON.



7) Set the display to zero by performing the following operation:

Press the <sup>ZERO</sup>3 key, select <sup>CAL</sup>1 (1: SET), and press the <sup>SET/CHG</sup> (SET/CHG) key.



CURRENT DATA ZERO CH1  
1 :SET  
2 :CLEAR  
ESC: CANCEL

8) Pressurize the pressure disc by using a press ram and take a reading on the measuring instrument.



## **⚠ CAUTION**

Keep the instrument in the dedicated case after use. To protect the pressure disc from dents and other damage, keep it wrapped in the chamois leather included with FM-2. We recommend that this instrument be calibrated annually.